

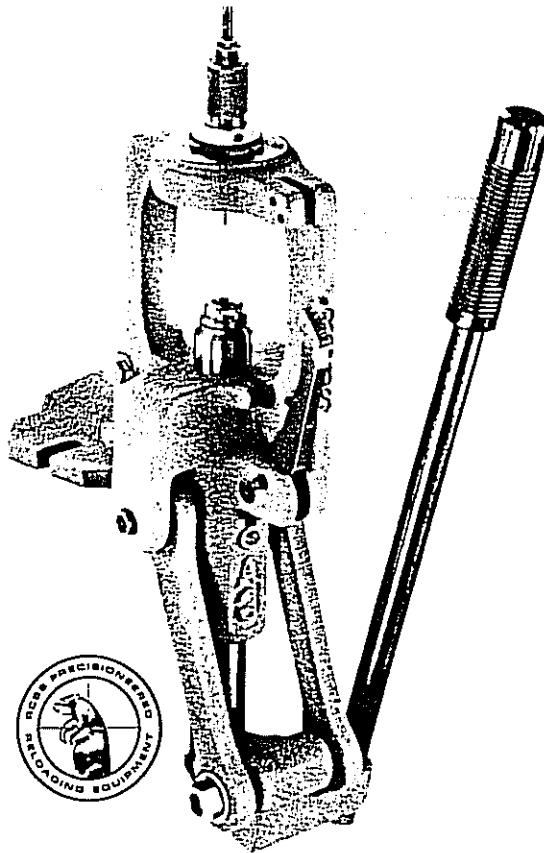

**PRECISIONEERED®**

# "A-3" PRESS INSTRUCTIONS

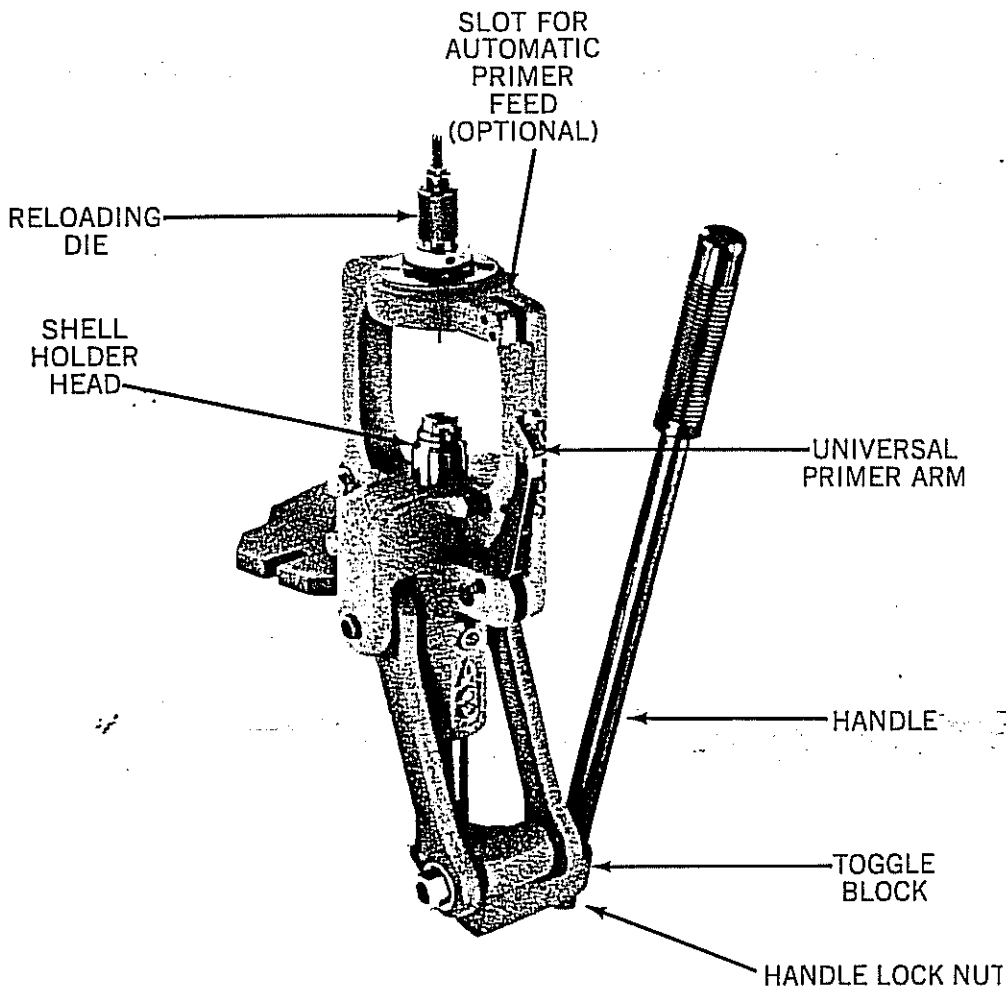



## 1. PRIMARY ASSEMBLY

Mount the press on the reloading bench or table with two  $\frac{3}{8}$ " bolts of the predetermined length. Or the press may be mounted temporarily with a "C" clamp.

Remove the Lock Nut from the Handle and install the threaded portion of the Handle through the Toggle Block as shown above. Attach the Lock Nut and tighten firmly. The Lock Nut must be tight at all times to avoid breakage of the Handle or Toggle Block.

## 2. DISPOSAL OF SPENT PRIMERS

The primers drop out of the press through a hole in the bottom of the Main Ram. A waste basket on the floor under the press will catch them.

### 3. THREAD SIZE

The Model "A-3" Press is furnished with a  $\frac{7}{8}$ "-14 bushing and most accessories may be used with it.

NOTE: The RCBS Standard Primer Pocket Swager is not designed for use with the Model "A-3" Press.

### 4. LUBRICATION OF PRESS

The press was lubricated before it was shipped from the factory. After use, it will be necessary to lubricate the various moving parts from time to time. Any gun oil may be used for this. If rust spots should appear, they should be lightly swabbed with gun oil and wiped dry.

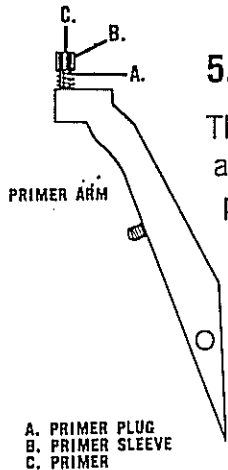

### 5. "A-3" PRIMER ARM

The "A-3" Primer Arm is furnished with interchangeable Primer Plugs and Sleeves for large and small primers. The Plugs and Sleeves may be changed without removal of the complete Primer Arm. To change, merely loosen the setscrew. Be sure the entire assembly is tight before priming. The Primer Arm may be removed by driving out the Primer Arm Pin at the base of the Primer Arm. See Page 5 for the RCBS Primer Plug and Sleeve Chart.

### 6. SHELL HOLDER HEAD

The press is equipped with the Removable Head Type Shell Holder for economy and convenience. The Shell Holder Head is installed with a slight twisting action to the left. To remove the Head, a slight twisting action to the right is required.

### 7. AUTOMATIC PRIMER FEED

The two setscrews on the front of the frame are for installation of the optional Automatic Primer Feed. See your dealer for this and other RCBS accessories for use on the Model "A-3" Press.



# SHELL HOLDER CHART

## GROUP 1: PART NO. 09201

.17 A&M Bee  
.17 Ackley Bee  
.218 Bee  
.218 Mashburn Bee  
.25-20 WCF  
  
.32-20 WCF  
.38 ACP Super Auto

## GROUP 2: PART NO. 09202

.219 Donaldson Wasp  
.219 Mashburn Zipper  
.219 Zipper  
.219 Zipper Improved  
.22 Savage Hi Power  
  
.22-30-30 Improved  
5.6x61 Vom Hoffe  
6mm-.30-30 Improved  
.25-35  
.25-35 Ackley Improved  
  
6.5x55  
6.5x55 Norwegian Krag  
6.5x58  
7.5 Schmidt Rubin  
7.5 MAS  
  
7.7 Jap  
.30-30 WCF  
.30-30 Ackley Improved  
.32 Winchester Special  
.32-40  
  
8x57R/360  
8x58 Rimmed  
8.15x46 Rimmed  
9.3x72 Rimmed  
.38-55  
10.75x68

## GROUP 3: PART NO. 09203

.22-250 (.22 Varminter)  
.22-250 Ackley Improved  
.240 Page Souper Pooper  
.240 Gibbs  
.240 Weatherby Magnum  
  
.243 Ackley Improved  
.243 RCBS  
.243 Super Rock Chucker (.30-06)  
.243 Winchester  
.244 Ackley Improved  
  
.244 Mashburn  
6mm Donaldson International  
6mm Remington (.244 Remington)  
6mm Remington International  
6mm-250 Savage  
  
6mm-284 Winchester  
6mm-06  
.25 Gibbs  
.25-308 Winchester  
.25-284 Winchester  
  
.25-06  
.25-06 Improved (40\*)  
.25-06 Mashburn Improved  
.250 Savage (.250-3000)  
.250 Savage Improved

.256 Newton  
6.5-06  
6.5-06 Ackley Improved (40\*)  
.260 AAR  
6.5 Gibbs

6.5x54 Kurtz Mauser  
6.5-284 Winchester  
.270 Gibbs  
.270 Improved  
.270 Winchester

.270-284 Winchester  
7mm Gibbs  
7x64  
7mm-06

7mm-06 Improved  
.280 Remington  
.280 Remington Improved  
.284 Winchester  
7.65 Belgian Mauser

.30 Gibbs  
.30-284 Winchester  
.30-06 Improved (40\*)  
.30-06  
8x57 Mauser (8mm Mauser)  
.300 Savage

.308 Winchester  
308 x 1.5  
8mm Gibbs  
8mm-06

8mm-06 Improved  
8x56 Mannlicher  
8x60  
7.92 Kurtz Mauser  
.35 Whelen

.35 Whelen Improved  
.358 Winchester  
9x57 Mauser (9mm Mauser)  
9x56 Mannlicher-Schoenauer  
9.3x57

9.3x62  
9.5x57  
.38-45  
.41 Colt  
.45 ACP

## GROUP 4: PART NO. 09204

.250 Ackley Magnum  
.257 Weatherby Magnum  
6.5 Remington Magnum  
6.5-300 Weatherby Magnum  
.264 Winchester Magnum

.270-338 Winchester  
.270 Weatherby Magnum  
7mm Ackley Magnum  
7mm-350 Remington  
7mm Mashburn Magnum

7mm Remington Magnum  
7mm Weatherby Magnum  
.30 Ackley Magnum  
.30 Alaskan Magnum  
.30-338 Winchester

.30 Newton  
.300 Magnum Improved (40\*)  
.300 H&H  
.300 Weatherby Magnum  
.300 Winchester Magnum

.308 Norma Magnum  
8mm-308 Norma  
8mm-338 Winchester  
.338 Winchester  
.340 Weatherby Magnum

.350 Remington  
.358 Norma Magnum  
9.3x74 Rimmed  
.375 H&H Magnum  
.375 H&H Magnum Improved

.375 Weatherby Magnum  
.375-338 Winchester  
.450 Ackley Magnum  
.450 Alaskan  
.458 Winchester Magnum  
.458x2" American

## GROUP 5: PART NO. 09205

.348 Ackley Improved  
.348 Winchester  
.360 Nitro #2  
.40-60 WCF  
.45-60 WCF

.450-348 Improved  
.50-110 WCF

## GROUP 6: PART NO. 09206

.22 Super Jet  
.22 Remington Jet  
.256 Winchester  
.357 Magnum

.38 S&W  
.38 Special

## GROUP 7: PART NO. 09207

.25 Krag  
.25 Short Krag  
.25 Ackley Krag Improved  
6.5x53 Rimmed  
6.5x68 S  
  
.30-40 Krag  
.30-40 Ackley Krag Improved  
.303 British  
8x68 S  
.35 Winchester  
  
.40-72 WCF  
.44 Russian

## GROUP 8: PART NO. 09208

.45 Auto Rimmed

## GROUP 9: PART NO. 09209

6.5 Mannlicher-Schoenauer (6.5x54)  
6.5x53  
6.5 Carcano  
7.35 Carcano  
.35 Remington

## GROUP 10: PART NO. 09210

.17 Javelina  
.17 Mach IV  
.17-221 Remington  
.17-222 Remington  
.17-222 Remington Magnum  
  
.17-223 Remington  
.22 Lovell R-2  
.221 Remington  
.222 Remington  
.222 Remington Magnum

CONTINUED ON NEXT PAGE

.223 Remington 6x47 Remington .25-20 Single Shot .380 Auto	GROUP 15: PART NO. 09215 6.5 Original Jap	GROUP 24: PART NO. 09224 .405 Winchester
GROUP 11: PART NO. 09211 .17-225 Winchester .220 Mashburn Improved .220 Swift .220 Swift Improved .220 Wilson Arrow .225 Winchester .240 Cobra .243 Rock Chucker (.257) 6mm-225 Winchester .257 Roberts .257 Improved (40*) 6.5x57 6.5-257 Roberts 6.5-257 Roberts Improved 7x57 Mauser (7mm Mauser) 7x57 Improved (40*)	GROUP 16: PART NO. 09216 .32 Winchester Self Loading .30 Luger .30 Mauser (7.63) 9mm Luger	GROUP 25: PART NO. 09225 8mm Nambu
GROUP 12: PART NO. 09212 .22 Hornet .22 K-Hornet	GROUP 17: PART NO. 09217 5.7mm Johnson .30 M1 Carbine .32 ACP	GROUP 26: PART NO. 09226 6.5x57 Rimmed 6.5x61 Sharpe & Hart 7x57 Rimmed 7x61 Sharpe & Hart 7x65 Rimmed .280 Ross 8x57 JR/.318 8x57 Rimmed .38-40 WCF .44-40 WCF .455 Webley
GROUP 13: PART NO. 09213 7.62 Russian 8x50 Rimmed 8x56 Mannlicher Rimmed 8x56 Rimmed Hungarian	GROUP 18: PART NO. 09218 .44 Magnum .44 Special	GROUP 27: PART NO. 09227 .224 Weatherby Magnum
GROUP 14: PART NO. 09214 .30-378 Weatherby Magnum 8mm Danish Krag .33 Winchester .38-56 WCF .378 Weatherby Magnum .40-65 WCF .40-82 WCF .45-70 .45-90 WCF .460 Weatherby Magnum	GROUP 19: PART NO. 09219 .25 Remington .30 Remington .32 Remington .35 Winchester Self Loading .351 Winchester Self Loading	GROUP 28: PART NO. 09228 .444 Marlin
	GROUP 20: PART NO. 09220 .45 Colt	GROUP 29: PART NO. 09229 .25 ACP
	GROUP 21: PART NO. 09221 6.5x58 Rimmed .303 Savage	GROUP 30: PART NO. 09230 .41 Magnum
	GROUP 22: PART NO. 09222 11mm (.43 Mauser) .43 Spanish	SPECIAL GROUP - Order by Caliber and Part Number 09235 6mm Lee Navy 09236 8mm Lebel 09237 .401 Winchester Self Loading 09238 .416 Rigby 09239 .45-75 WCF 09240 .50-70 WCF
	GROUP 23: PART NO. 09223 .32 S&W Long .32 S&W Short	

## RCBS PRIMER PLUG & SLEEVE CHART

Current primers produced by the major manufacturers use the large or small Primer Plug and Sleeve as shown in the chart below.

### LARGE

Alcan Large Rifle  
Alcan Large Pistol  
CCI #200 Large Rifle  
CCI #300 Large Pistol  
CCI Magnum #250 Large Rifle  
CCI Magnum #350 Large Pistol  
Remington #2½ Large Pistol  
Remington #9½ Large Rifle  
Remington Magnum #9½M Large Rifle  
Winchester-Western #7-111 Large Pistol  
Winchester-Western #8½-120 Large Rifle  
Federal #150 Large Pistol  
Federal #210 Large Rifle  
Federal Magnum #215 Large Rifle

### SMALL

Alcan Small Rifle  
Alcan Small Pistol  
CCI #400 Small Rifle  
CCI #500 Small Pistol  
CCI Magnum #450 Small Rifle  
CCI Magnum #550 Small Pistol  
Remington #1½ Small Pistol  
Remington #6½ Small Rifle  
Remington Magnum #7½ Small Rifle  
Winchester-Western #1½-108 Small Pistol  
Winchester-Western #6½-116 Small Rifle  
Federal #100 Small Pistol  
Federal #200 Small Rifle

# MODEL "A-3" PRESS PARTS LIST

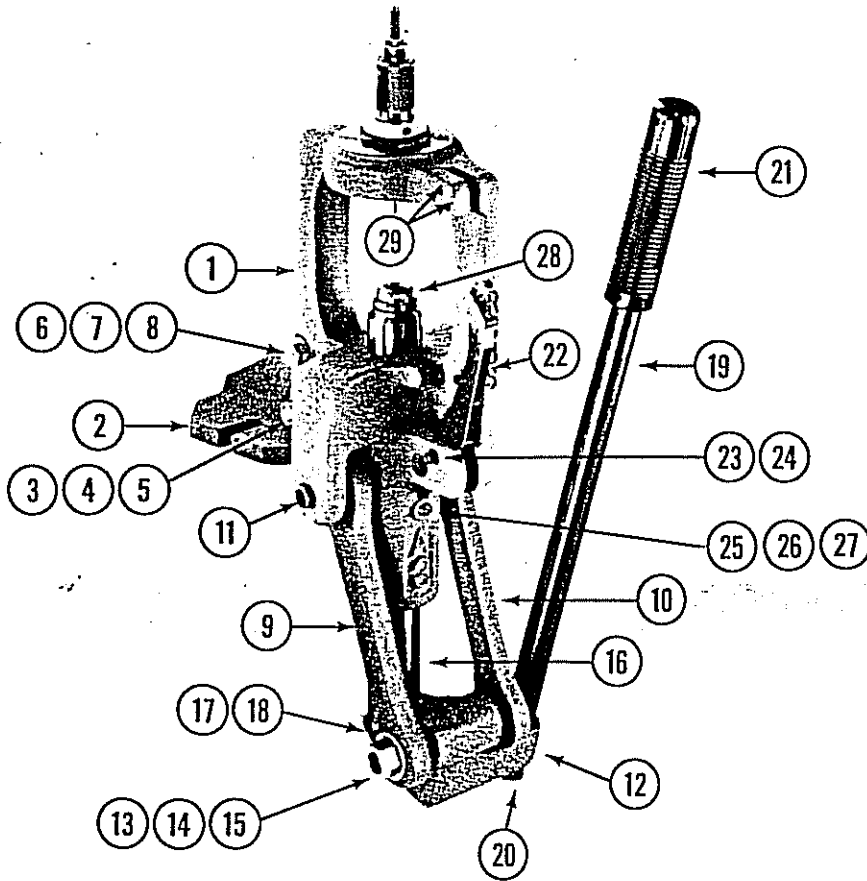

Key	Part No.	Description	Price	Key	Part No.	Description	Price
1	09184	Frame	\$36.00	15	09163	Toggle Block Bolt Washer	.30
2	09151	Mounting Bracket	6.00	16	09186	Main Ram	12.00
3	09152	Mounting Bracket Bolt, 3/8"	.30	17	09165	Main Ram Pin	1.00
4	09153	Mounting Bracket Bolt Nut, 3/8"	.30	18	09166	Pin Spring Clip (4)	.30
5	09154	Mounting Bracket Bolt Washer, 3/8"	.30	19	09188	Handle	2.50
6	09155	Mounting Bracket Bolt, 5/16"	.30	20	09136	Handle Nut	.30
7	09156	Mounting Bracket Bolt Nut, 5/16"	.30	21	09137	Handle Grip	.30
8	09157	Mounting Bracket Bolt Washer, 5/16"	.30	22	09187	Primer Arm	6.00
9	09158	Linkage Arm, Left	4.50	23	09171	Primer Arm Pin	.30
10	09159	Linkage Arm, Right	4.50	24	09172	Primer Arm Pin Spring Clip	.30
11	09178	Linkage Arm Pin (2)	1.00	25	09173	Primer Arm Spring (Flat)	.30
12	09185	Toggle Block	12.00	26	09174	Primer Arm Spring Screw	.30
13	09161	Toggle Block Bolt	1.50	27	09175	Primer Arm Spring Screw Washer	.30
14	09162	Toggle Block Bolt Nut	.30	28	09133	Main Ram Spring Clip	.30
				29	09112	Setscrew, 10/32x1/4" (2)	.30

—Prices & Specifications Subject to Change—